

Fixed Grooming Arm (Option)

Shor-Line offers two grooming table top sizes, Standard model measuring 26x42.5" and Large measuring 26x48". Ensure the bracket is correct for the table. The standard arm bracket will NOT fit on a large table.

The fixed grooming arm is mounted on the opposite end of the grooming table. The arm bracket is bolted to the underside of the Shor-Line Elite Grooming Table top frame, pre-drilled holes for convenience.

To install the shepherds hook into the height adjustment bracket the lower slide stop must be removed from the grooming arm. Remove the acorn nut, spacers and bolt. If the arm is equipped with post end plug/scuff ball, remove before installing the shepherds hook.

The scuff ball, bolt and tube insert nut (with teeth) will be inserted into and over the end of the tube once the shepherds hook is inserted into the fixed arm bracket.

Item	Part #	Description
	803.3221.00	Fixed Grooming Arm Kit (Standard Top Model)
	803.3221.08	Fixed Grooming Arm Kit (Large Top Model)
01	703.3220.22	Fixed Arm Bracket
	703.3220.45	Fixed Arm Bracket (Large Top Model)
02	• 062.2525.04	• 1/4-20x2 1/2" Hex Hd Screw, Fixed Arm Bracket
03	• 064.2500.02	• 1/4-20 SS Hex Nylock Nut, Fixed Arm Bracket
04		Height Adjustment Lock Assembly
05	• 062.2525.04	• Lock Knob, Adjustment Lock
06	300.1282.10	Shepherds Hook Grooming Arm
07	• 062.2515.11	• 1/4-20x1 1/2" Eye Bolt, Shepherds Hook
08	• 085.1018.00	• 1/4-20 SS Hex Acorn Nut, Shepherds Hook
09	• 062.2520.03	• 1/4-20x2" Hex Cap Screw, Slide Stop
10	• 310.0739.00	• .50Dx.257IDx.313LG Spacer, Slide Stop
11	• 064.2500.16	• 1/4-20 SS Hex Acorn Nut, Slide Stop
12		Grooming Arm Scuff Ball Kit
13	• 181.3220.00	• Scuff Ball
14	• 300.2451.00	• Tube Insert Nut, Scuff Ball
15	• 062.3107.09	• 1/4x3/4" Long Shoulder Bolt, Scuff Ball
	140.0001.32	Grooming Loop (Not Shown)

Contact Shor-Line at (800.444.1579)

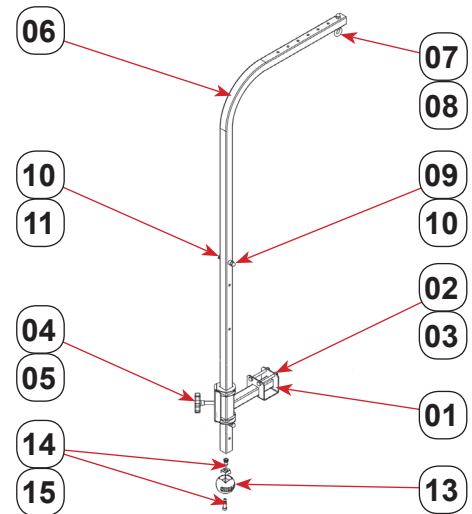

WARNING

WEAR PERSONAL PROTECTIVE EQUIPMENT (PPE), such as, but not limited to, eye protection, protective gloves and Metatarsal/foot protection during installation. Failure to do so could result in SERIOUS INJURY or DEATH.

Do NOT use the table functions before checking to ensure the unit and surrounding area are clear of personnel, animals and obstructions. Failure to do so could result in SERIOUS INJURY or DEATH.

Keep personnel and animals clear of the foot operated lift control switch, unintentional table functions (movement) could occur. Failure to do so could result in SERIOUS INJURY or DEATH.

CAUTION

Enlist help and USE SAFE LIFTING PRACTICES during assembly, installation and moving equipment.

This product is intended to be used for animals only. Do NOT use for anything other than the intended purpose.

Keep hands clear of possible pinch areas during installation, which if not avoided, could result in MINOR to MODERATE INJURY.

Stainless steel has sharp edges, stay clear of and DO NOT TOUCH exposed edges which, if not avoided, could result in MINOR to MODERATE INJURY.

NOTICE

The grooming arm (shepherds hook) must be installed onto the grooming table before installing the scuff ball.

STEP 1: Locate the two pre-drilled holes and secure the fixed arm bracket to the underside of the table top frame using hardware provided.

STEP 2: Slide the height adjustment lock assembly over the end of the arm fixed bracket if it is not already installed. Loosen the bracket knob.

STEP 3: Slide the straight long end of the grooming arm down into and through the top of the adjustment bracket. Ensure the top of the shepherds hook is facing towards the center of the table. Tighten the knob to lock in place.

STEP 4: Reinstall the lower slide stop pin and the scuff ball.

